

T860 / T861

INSTALLATION INSTRUCTIONS

TRP BRAKES

688 W. Amidan Dr. 4X-1
 Ogden, UT 84404
 Toll Free: 1-877-807-4162
 Direct: 1-650-965-4442

Email: info@trpbrakes.com
 Web: www.trpbrakes.com

SAFETY WARNINGS

- Improper use of your bicycle's brake system may result in loss of control or an accident which could lead to severe injury. Because each bicycle may handle differently, be sure to learn the proper braking technique (including brake lever force and bicycle control characteristics) for your bicycle. Consult your bicycle dealer and/or the bicycle owner's manual and practice your riding and braking technique.
- Securely tighten the caliper brake mounting hardware to the specified torque.
 When re-installing, apply blue thread retaining compound to the brake mounting bolts threads and tighten to specified torque using a calibrated torque wrench.
- If the mounting bolt(s) become loose, this could cause the brake to work improperly and cause an accident. This is a particular danger with the front wheel as the rider may be thrown forward resulting in serious injury.
- Brakes designed for use as rear brakes should not be used as front brakes and vice versa.
- Read the service instructions carefully prior to installing the brakes. Loose, worn or damaged parts may cause serious injury.
- Be careful not to allow any oil or grease to get onto the brake pads. If the pads become contaminated, they should be replaced and the braking surface of the rims cleaned carefully, otherwise the brakes may not work effectively.
- Always make sure the front and rear brakes are working correctly before you ride the bicycle.
- The required stopping distance will be longer in wet conditions. Tires will also skid more easily, which can result in loss of control. Reduce your speed by applying the brakes early and gently.
- If using standard Tektro brake pads in combination with ceramic-coated or carbon fiber rims, the pads will wear more quickly than normal. Pads specifically designed for carbon fiber rim surfaces are available from Tektro/TRP Brakes. Also consult your rim manufacturer for approved pads.
- Pads should be replaced if they have worn to the point that the grooves are no longer visible.
- Parts are not guaranteed against natural wear or deterioration resulting from normal use or crash damage.
- If you are unfamiliar with any element of assembly or maintenance of this brake system, consult a qualified mechanic or contact Tektro / TRP Brakes Customer Service.

TRP hydraulic disc brakes are **warranted** against manufacturing defects in materials and / or workmanship for a period of two years from the date of original retail purchase. Not covered under this warranty is damage resulting from improper installation, adjustment or maintenance, lack of maintenance, alterations, crashes or use judged by Tektro to be excessive or abusive. For warranty related questions or more information please contact a TRP Service Center or e-mail at info@trpcycling.com

EXPLODED VIEW OF BRAKE ASSEMBLY

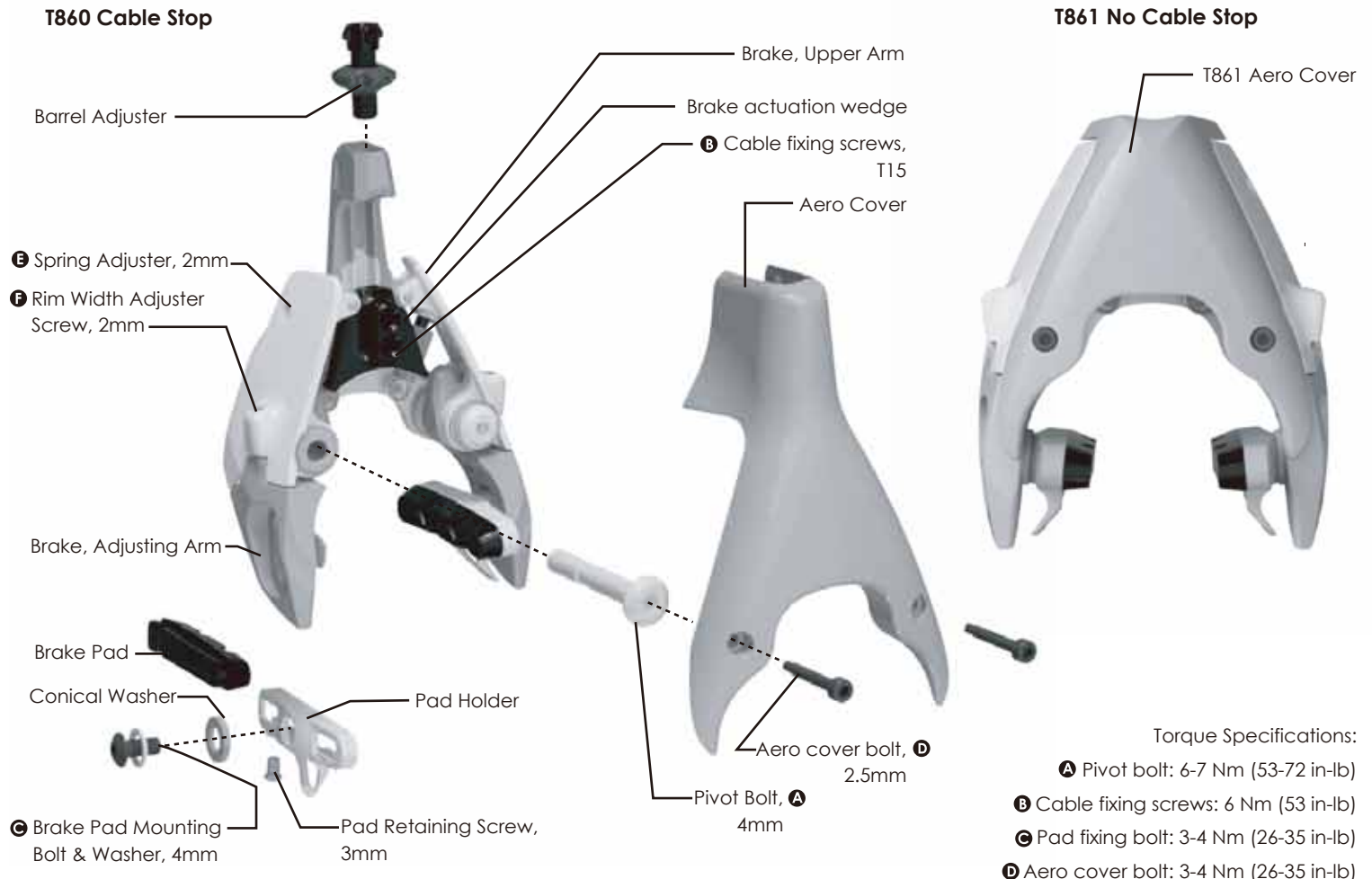

INSTALLATION ON FRAME

Tools needed:
4mm hex wrench
Torque wrench

1. The T860/861 is designed for Direct Mount specific frames. The T861 requires the use of a cable stop integrated into a component or directly on the frame.
2. Install each pivot bolt **A** into its respective hole on the frame or fork. Engage a few threads of each bolt alternately, instead of threading one bolt all the way in.
3. Tighten the pivot bolts to 6-7 Nm (53-62 in-lbs) torque using a torque wrench.
3. Actuate the brake by pushing on the brake actuation wedge to make sure there is free movement with no friction.
4. If installed on the frame under the bottom bracket, rotate the cranks to check clearance with crank mounted power meters.

4mm Hex wrench
Torque: 6-7 Nm (53-62 in-lbs)

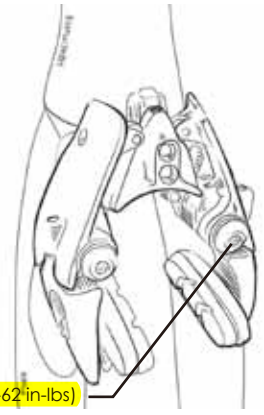

BRAKE SET-UP

Tools needed:
2.5mm hex wrench Compressionless housing cutters Park BT-2 '4th Hand' tool (optional)
2mm hex wrench Torque wrench
T15 Torx wrench Cable cutters

Cable Installation

Compressionless, (linear strand,) brake housing, is recommended for T860/T861 road brakes to yield the best performance. Sealing systems other than that supplied with your TRP brake are not recommended as they may create excess friction and affect the brake lever return performance. Route housing to minimize tight bends and acute angles.

A short length of spiral wound is best for use at the brake lever to accommodate the sharp bend at the handlebar.

Take care that the ends of the housing are cut cleanly and are flat as possible.

IMPORTANT: For T861 - Install the aero cover on the cable prior to installing the cable in the brake actuation wedge.

Install the cable in the brake actuation wedge.

B Tighten the T15 cable fixing screws to 6 Nm (53 in-lb).

Squeeze the brake lever about 10 times to stretch the cable and seat the housing. Retighten the cable if necessary. Using the BT-2 '4th hand' tool is very helpful at this step.

Brake Pad Adjustment

Brake pads will need to be adjusted to fit your particular rim. **Including** a slight toe-in will reduce noise or vibration.

Use a 4mm hex wrench to reposition the brake pad holders **C**. Tighten to 3-4 Nm (26-35 in-lb). The brake arms can be adjusted to your rim width using the 2mm hex wrench. If this feature is used frequently, you may need to reapply blue thread retainer occasionally to the screw threads.

Spring Tension Adjustment

Once the pads have been set to your rims, the spring balance can be adjusted with the 2mm Spring Adjuster Screw **E**. Threading the set-screw in will increase spring tension. Threading out will reduce spring tension. Balancing the springs should allow pads to contact the rim simultaneously.

Rim Width Adjustment

The Rim Width Adjuster Screw **F** uses a 2mm hex wrench for adjustment. This feature allows quick setting of the brake to **accommodate** changing out wheels with different rim widths. This feature can also be used for dealing with frame alignment or wheel dish issues.

Install Aero Cover

If you've not already done so, cut the cable cleanly so that it does not contact the tire. (Larger tires at higher pressure will need more clearance.)

Install the aero cover and tighten the 2.5mm Aero cover bolts **D** to 3-4 Nm (23-35 in-lb.)

Check

Check that the brake is operating correctly and that friction is minimal. Brake pad clearance can be adjusted using the rim width adjust screws **F** on each brake arm.

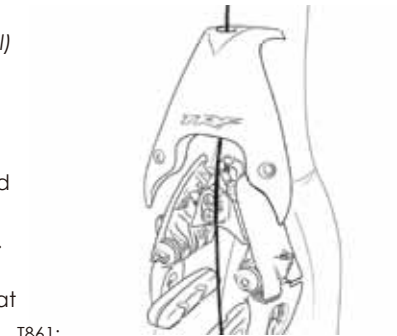

T861:
Install aero cover BEFORE installing cable in actuation wedge.

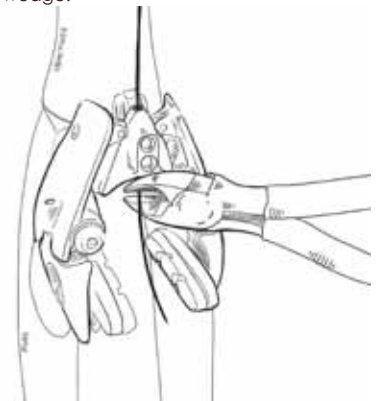

Trim cable before installing aero cover

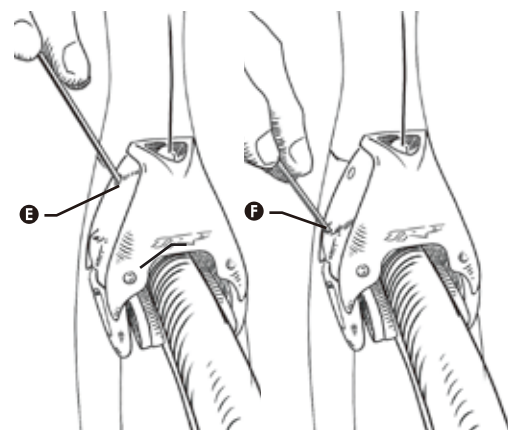

Spring adjustment

Rim width adjustment

INSTALLING AND ADJUSTING BRAKE PADS

Changing Brake Pads

Remove the pad retaining screw. Remove the pad by sliding it along the groove of the pad holder.

There are two different types of pads and pad holders to be used in the left and right positions. (Note the orientation of the pads and holders on the bike if removing to replace the pads.) Slide the new pad into the grooves of the pad holder making sure of the direction and fixing bolt hole position relative to the recess in the brake pad.

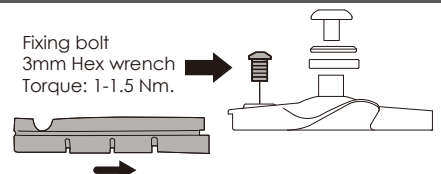

Fixing bolt
3mm Hex wrench
Torque: 1-1.5 Nm.

For questions about setup, usage or general inquiries, please contact TRP by e-mail at info@trpbrakes.com or by phone toll free in US, 877-807-4162 or outside US 1-801-648-7079.